

The Point

4.2m X 3.2m

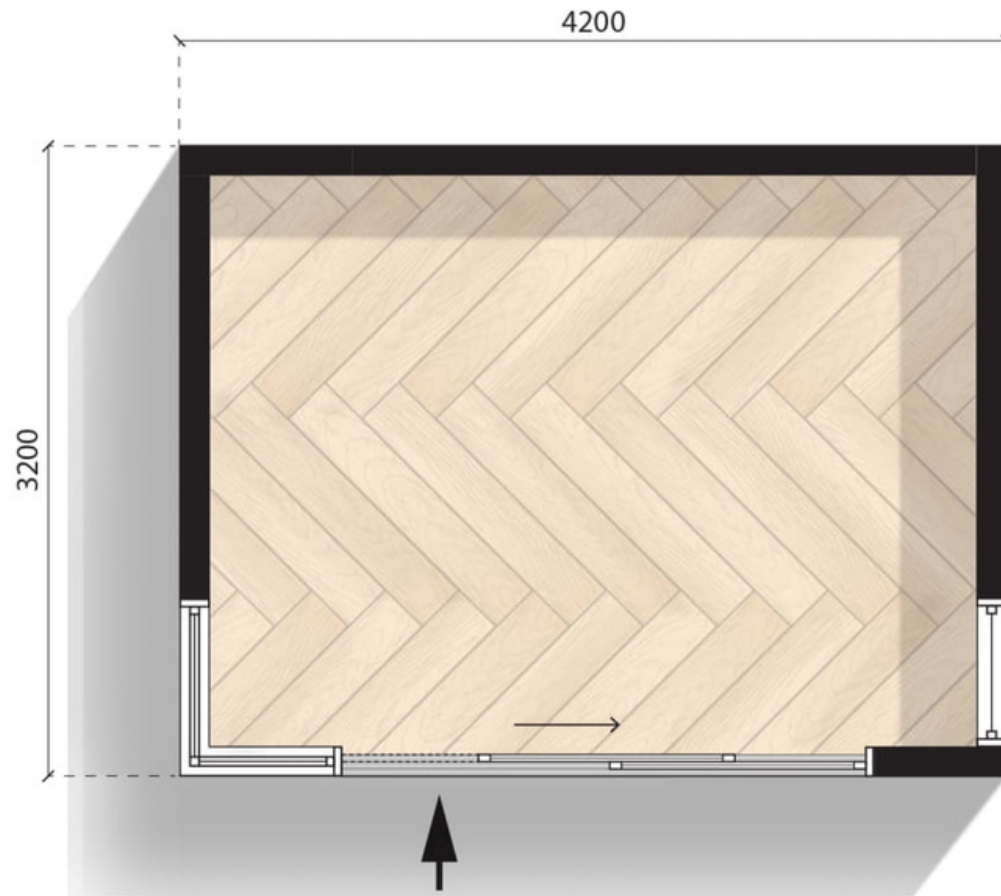

Please note: floor plans are intended to give a general indication of the proposed layout only. All images and dimensions are not intended to form part any contract or warranty.



The Point

4.2m X 3.2m

Configuration: Open plan

MODN-4x3.2-POINT-OP



MODNPODS

— MODULAR LIVING —

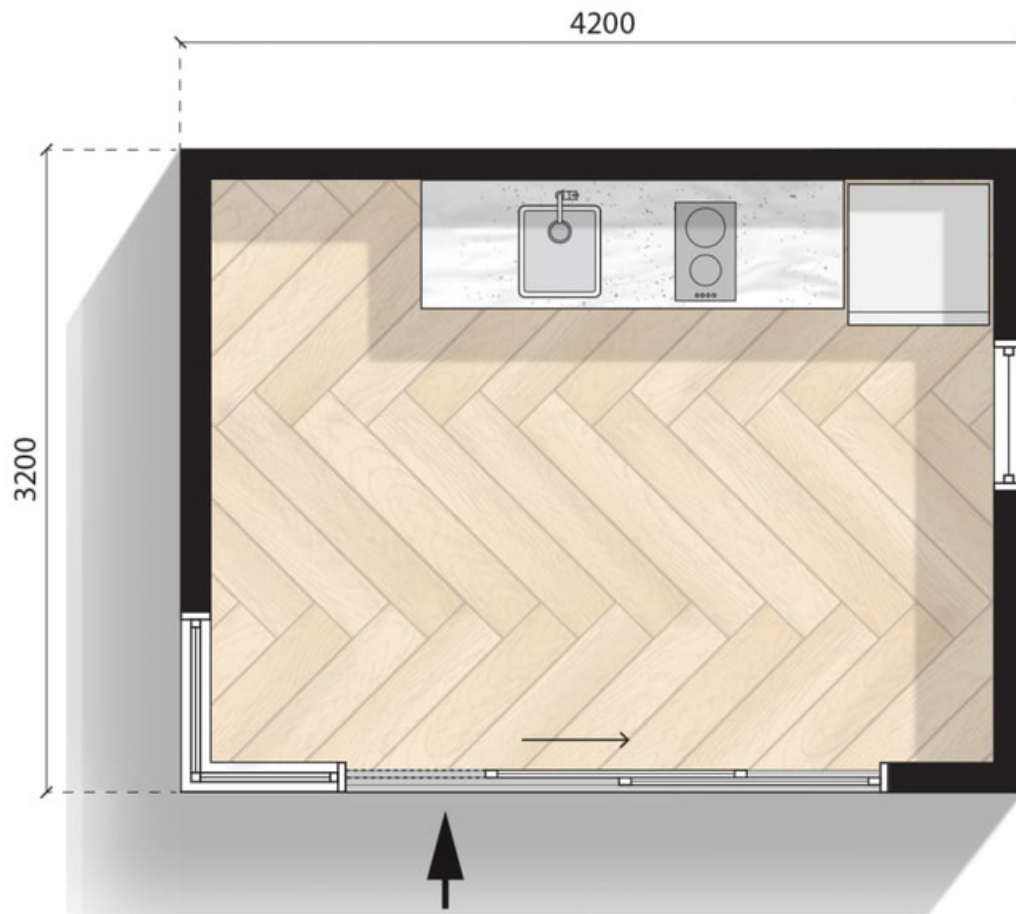

The Point

4.2m X 3.2m

Configuration: K2 Kitchenette

MODN-4x3.2-POINT-KT2



MODNPODS

MODULAR LIVING



MODNPODS

— MODULAR LIVING —

P: 1 300 418 226

E: info@modnpods.com.au

W: modnpods.com.au



Scan or click the QR
Code to download
our spec sheet.

For up-to-date pricing, head to modnpods.com.au/pricing