

The Pass

8.2m X 4.2m

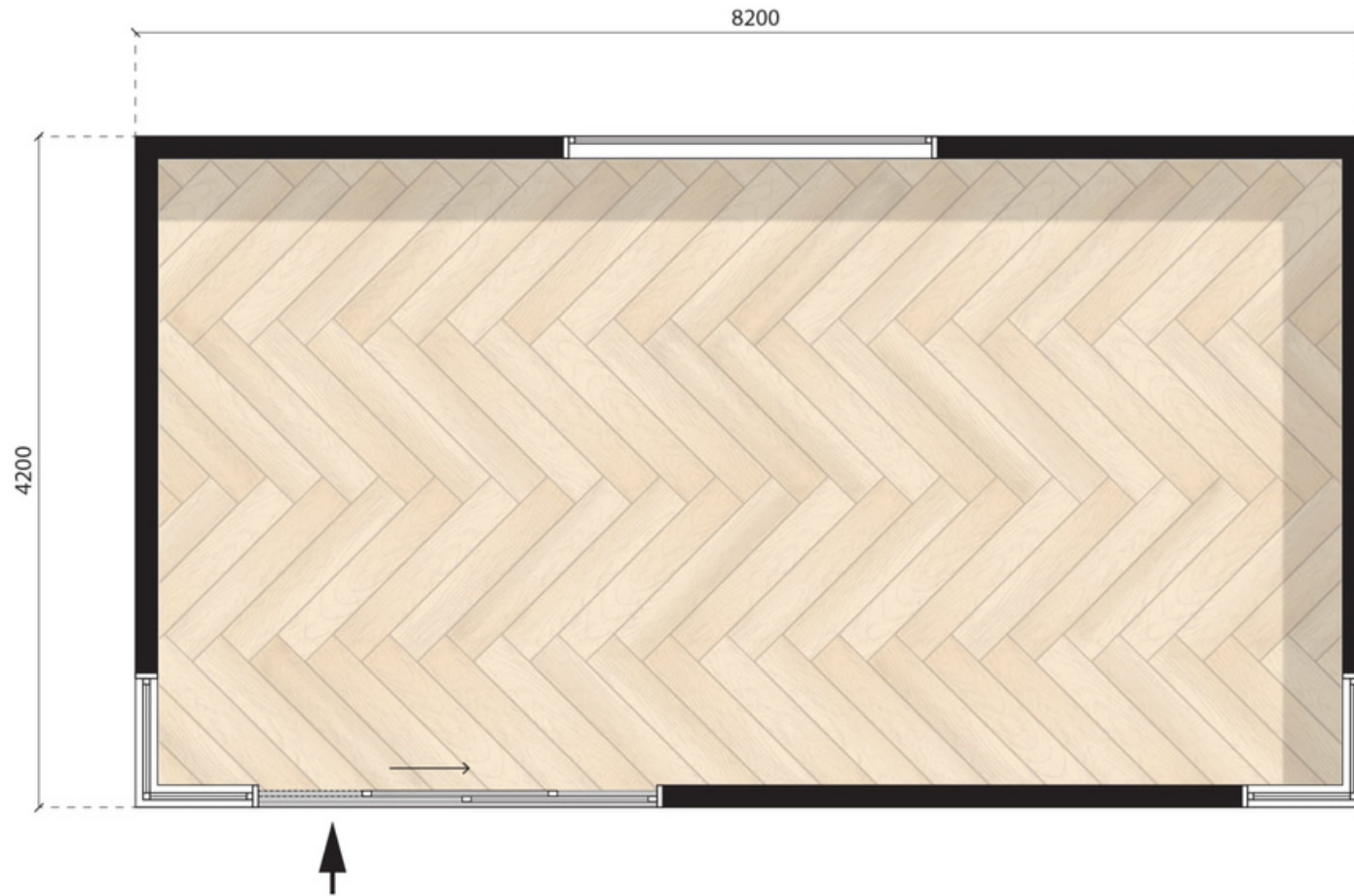

Please note: floor plans are intended to give a general indication of the proposed layout only. All images and dimensions are not intended to form part any contract or warranty.



The Pass

8.2m X 4.2m

Configuration: Open plan

MODN-8x4.2-PASS-OP



MODNPODS

MODULAR LIVING

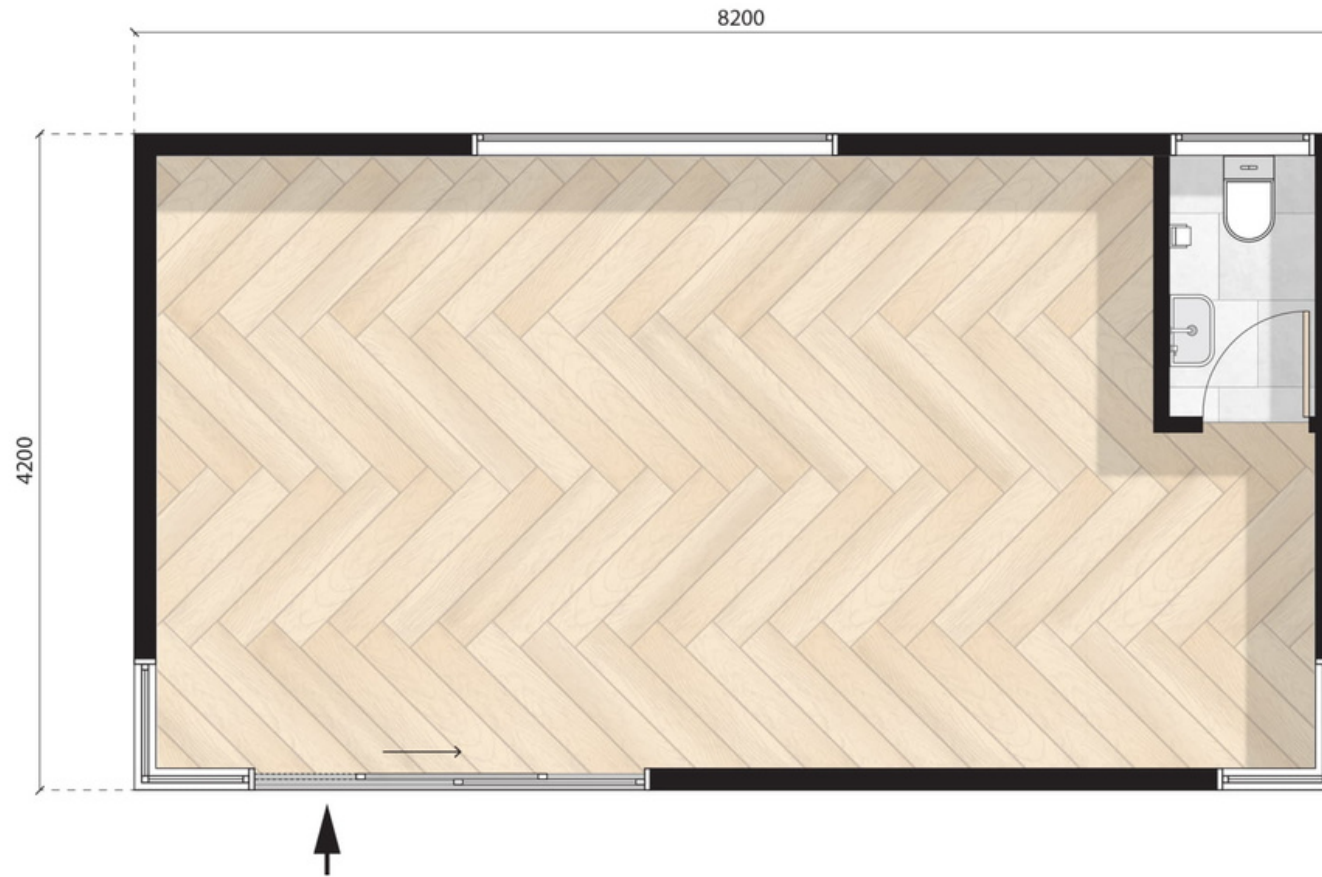

The Pass

8.2m X 4.2m

Configuration: Powder room

MODN-8x4.2-PASS-PR



MODNPODS

MODULAR LIVING

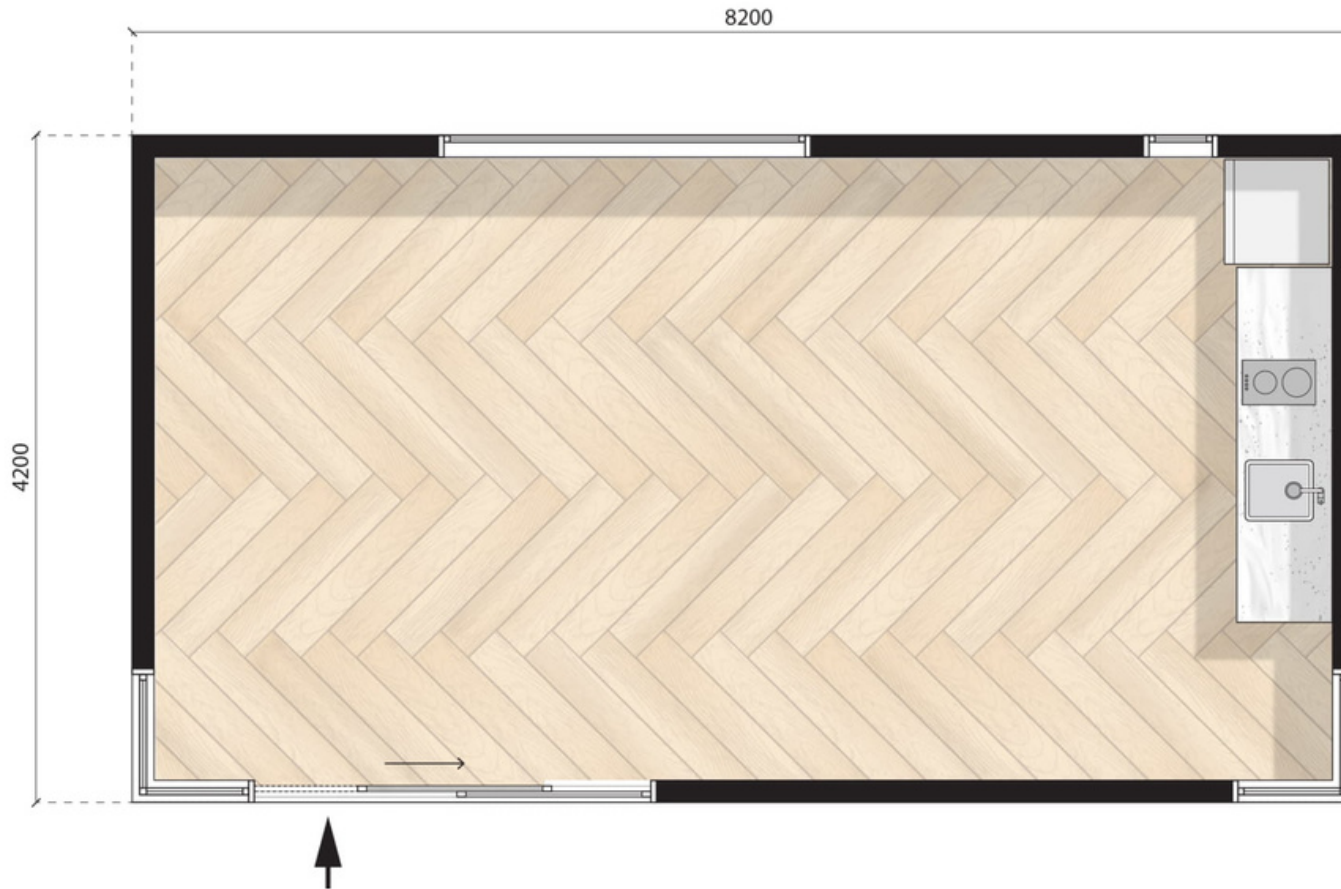

The Pass

8.2m X 4.2m

Configuration: K2 Kitchenette

MODN-8x4.2-PASS-KT2



MODNPODS

MODULAR LIVING

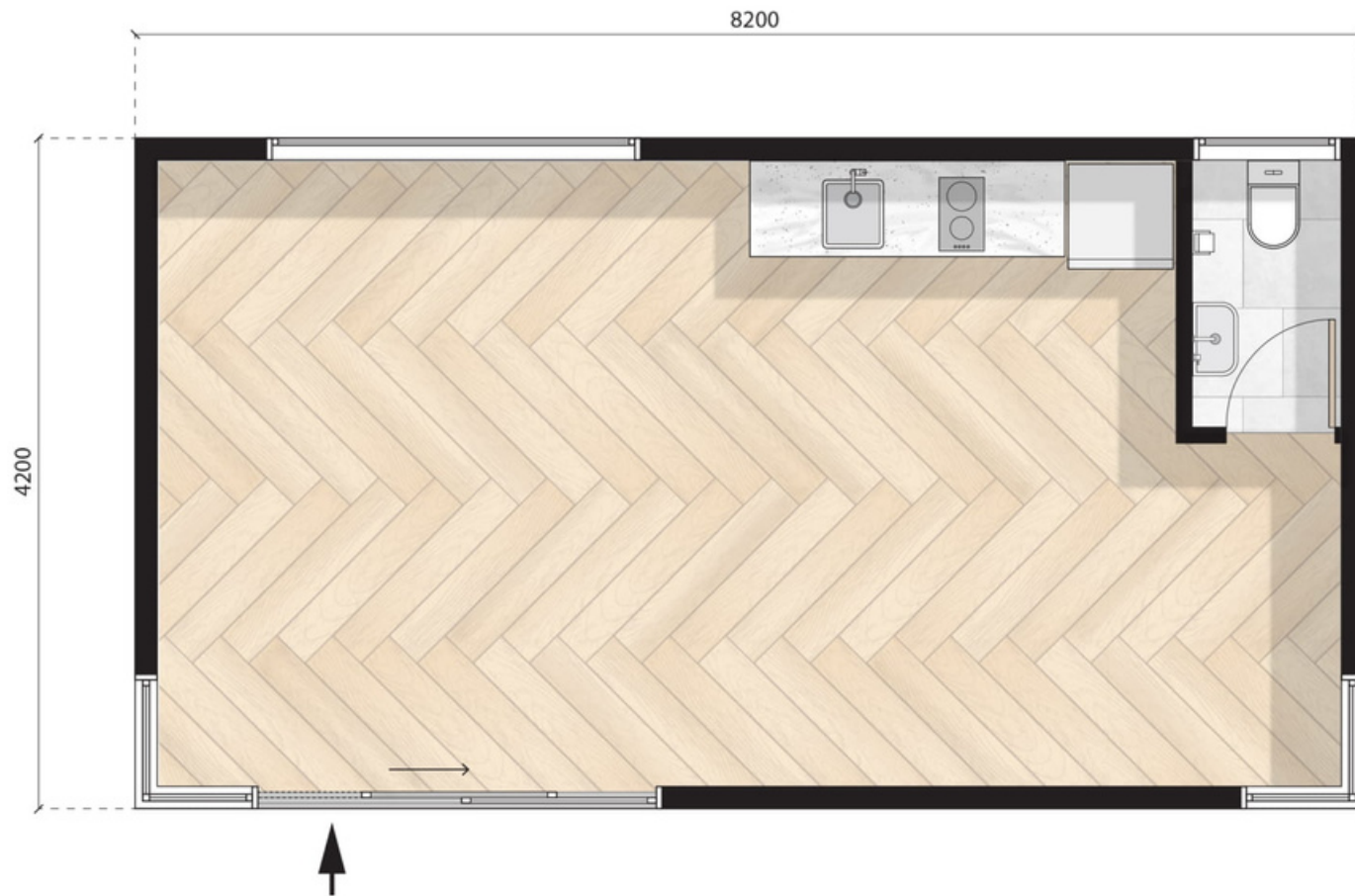

The Pass

8.2m X 4.2m

Configuration: Powder room + K1 kitchenette

MODN-8x4.2-PASS-KT2PR



MODNPODS

MODULAR LIVING

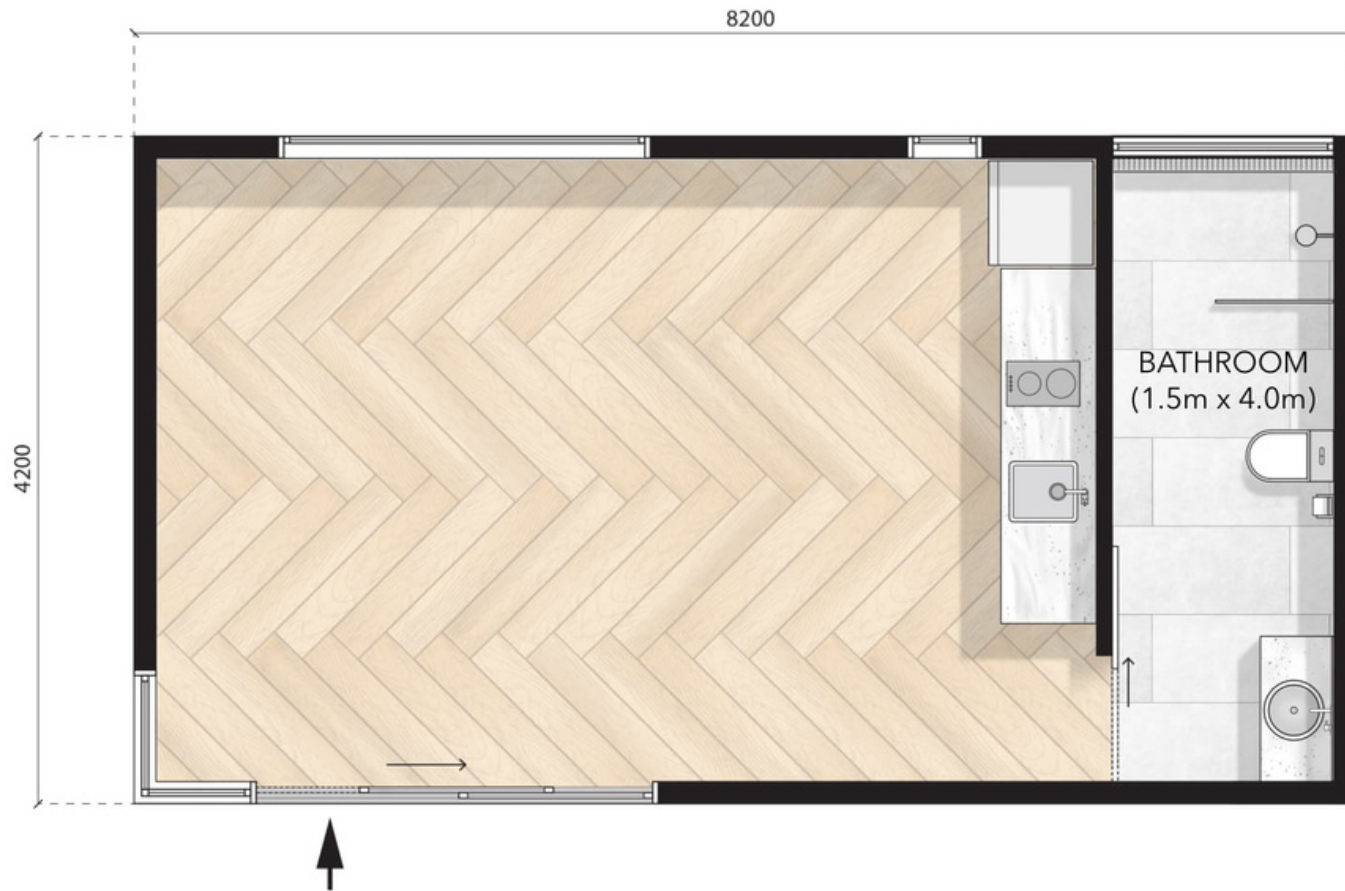

The Pass

8.2m X 4.2m

Configuration: B2 Bathroom + K2 kitchenette

MODN-8x4.2-PASS-KT2BR2



MODNPODS

MODULAR LIVING



The Pass

8.2m X 4.2m

Configuration: B2 Bathroom

MODN-8x4.2-PASS-BR2KT2L



MODNPODS

MODULAR LIVING

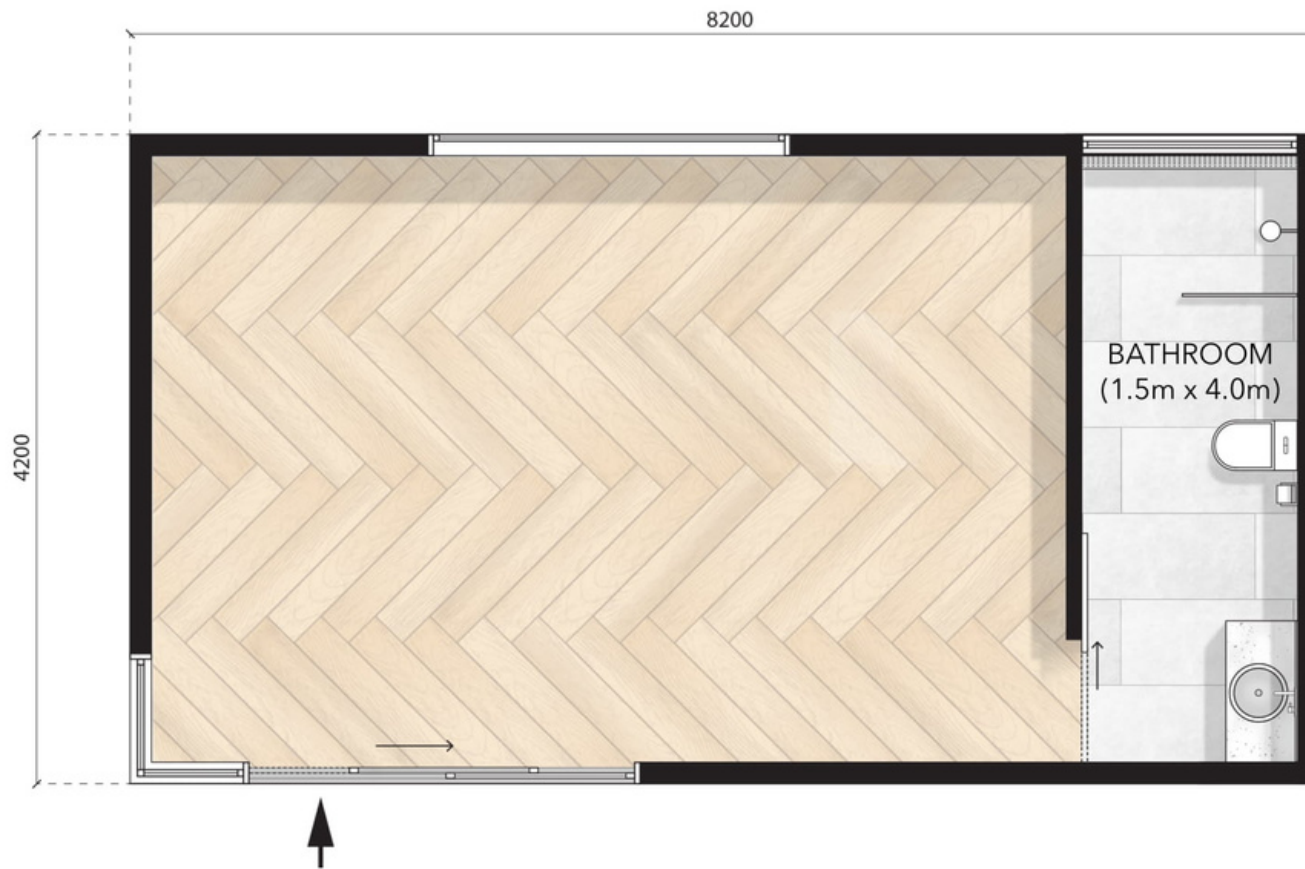

The Pass

8.2m X 4.2m

Configuration: K2 Kitchenette, B2 bathroom

MODN-12x4.2-KING-KT2BR2



MODNPODS

MODULAR LIVING



MODNPODS

— MODULAR LIVING —

P: 1 300 418 226

E: info@modnpods.com.au

W: modnpods.com.au



Scan or click the QR
Code to download
our spec sheet.

For up-to-date pricing, head to modnpods.com.au/pricing